

# NEX140

Injection type : ① 12E [Screw diameter :  $\phi 28 / \phi 32 / \phi 36$ ]  
 ② 18E [Screw diameter :  $\phi 32 / \phi 36 / \phi 40$ ]\*  
 ③ 25E [Screw diameter :  $\phi 36 / \phi 40 / \phi 45$ ]

The ★ indicates the standard combination.

## EXTERNAL VIEW

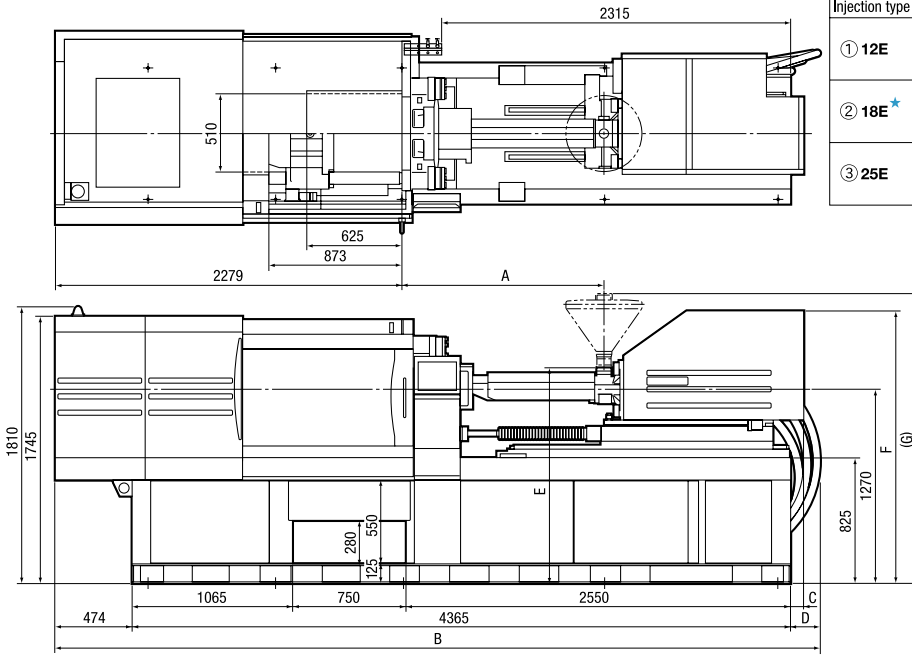

Injection type	Screw dia.	A	B	C	D	E	F	G
① 12E	28	719.5~1059.5						
	32		4839	—	—	1425	1719	1915
	36	897~1237						
② 18E★	32	827~1262	4871	10	32			
	36	995.5~1345.5	5039	94.5	200	1430	1790	1920
	40							
③ 25E	36	921~1271	4970	42.5	131			
	40	1110~1460	5159	231.5	320	1435	1790	2008
	45							

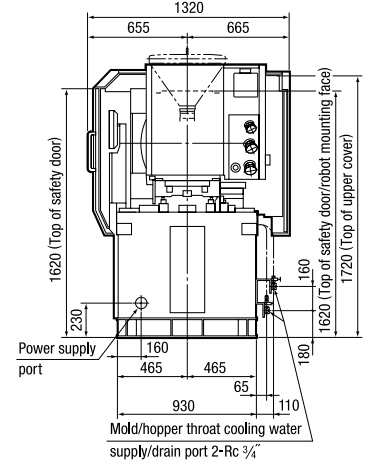

## FOUNDATION DIAGRAM

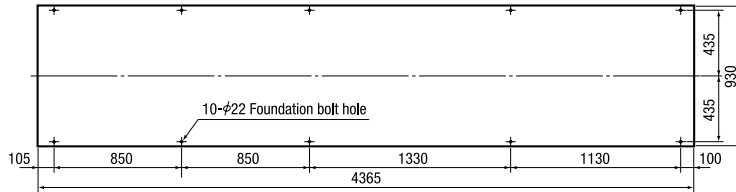

## HOPPER FIXATION DIAGRAM

\* For more details, please refer to the "hopper installation diagram."

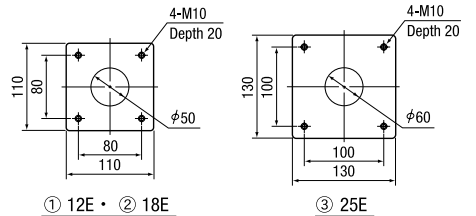

## MOLD ATTACHMENT DIAGRAM

\*The minimum mold dimensions of 325 mm (H) × 325 mm (V) are required in order to achieve the maximum clamping force.

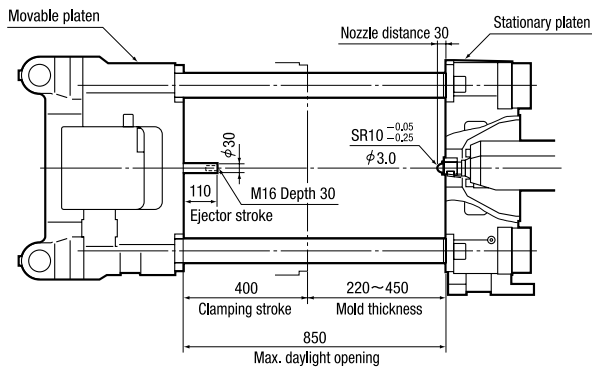

## ROBOT FIXATION DIAGRAM

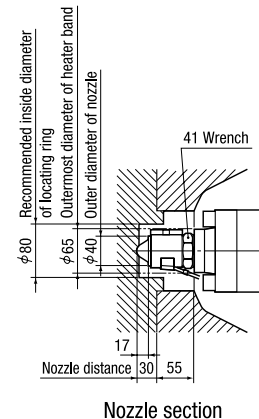
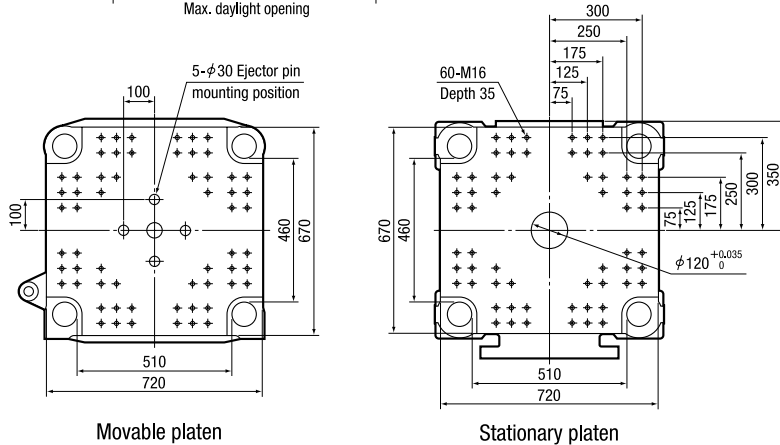
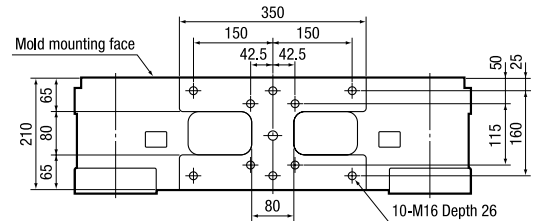

● Subject to change without notice for performance upgrades.